

BEAM PROPERTIES

$A_B = 489,200 \text{ mm}^2$
 $I_B = 46,011 \times 10^6 \text{ mm}^4$
 $S_{TB} = 109,028 \times 10^3 \text{ mm}^3$
 $S_{BB} = 110,605 \times 10^3 \text{ mm}^3$
 $Y_{TB} = 422.0 \text{ mm}$
 $Y_{BB} = 416.0 \text{ mm}$
 $W_t = 11.55 \text{ kN/m}$

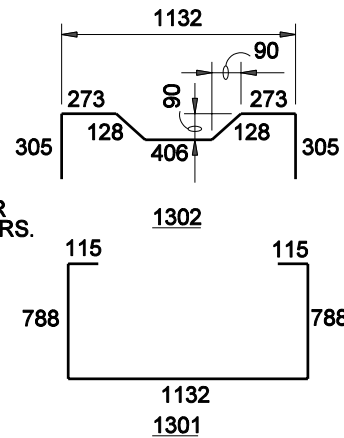
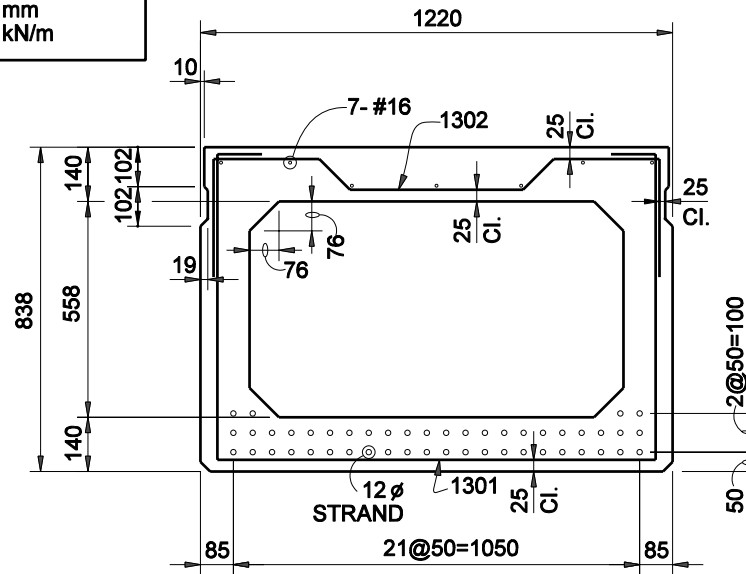

NOTE:
 USE 50 Ø PIN FOR
 BENDING ALL BARS.

BOX BEAM
TYPE WS 838x1220
Figure 63-15Q